

Swing Rotor, GRS-B-r250-4

- 4 loadings
- Max. RPM : 4,000
- Angle from axis during rotation: $\angle 90^\circ$
- Supplied with a lubricant

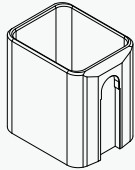

250 mL Rectangular Bucket
GLB-r250-r250

Max. RPM / RCF : 4,000 / 3,134
 Max. Radius (mm) : 175.2
 Hole dimension (w x d x h, mm) : 86 x 70.3 x 98.5
 Max. height for tube fit (mm) : 130
 Hole bottom type : Flat

Tube								
Tube capacity (mL)	1.5/2.0	2.0 ~ 4 mL VT	4 ~ 7 mL VT	14 mL	8 ~ 10 mL VT	15	15 mL conical	50
Tube Dimension (Φ x L, mm)	11 x 38	13 x 75	13 x 100	15.7 x 96	16 x 100	16 x 120	17 x 120	29 x 108
Adapter								
Cat. No.	GAM-m20-20(r250)	GAM-5-12(r250)	GAM-5-12(r250)	GAM-15-12(r250)	GAM-15-12(r250)	GAM-15-12(r250)	GAM-c15-9(r250)	GAM-50-4(r250)
Rack capacity (ea / 4)	20 / 80	12 / 48	12 / 48	12 / 48	12 / 48	12 / 48	9 / 36	4 / 16
Rack hole dimension (Φ x L,mm)	11.3 x 39	13.5 x 58	13.5 x 80	17.5 x 59	17.5 x 90	17.5 x 90	17.5 x 90	30.2 x 90
Rack hole bottom type	Round	Round	Round	Round	Round	Round	Conical	Round
Max. height tube fit (mm)	115	120	120	120	120	120	120	120
Max. radius (mm)	170	173.2	173.2	173.2	173.2	173.2	175.2	173.2
Max. RCF (g-force)	3,041	3,095	3,095	3,095	3,095	3,095	3,134	3,095

Tube							
Tube capacity (mL)	25mL conical	25mL conical	50 mL conical	50 mL conical (skirted)	15	85	250 mL
Tube Dimension (Φ x L, mm)	28.5 x 83	28.5 x 78.5	29.5 x 118	29.5 x 118	16 x 120	38 x 106	61.5 x 128
Adapter							
Cat. No.	GAM-c50-3(r250)	GAM-c50-3(r250)	GAM-c50-3(r250)	GAM-sc50(r250)	GAM-85-2(r250)		GAS-250(r250)
Rack capacity (ea / 4)	3 / 12	3 / 12	3 / 12	4/16	2 / 8		1 / 4
Rack hole dimension (Φ x L,mm)	30.5 x 60	30.5 x 60	30.5 x 90	29.8 x 93.5	17 x 86.5	38.5 x 86.5	62.5 x 87
Rack hole bottom type	Conical	Conical	Conical	Flat	Round		Flat
Max. height tube fit (mm)	120	120	120	126	120		130
Max. radius (mm)	175.2	175.2	175.2	172	172.5		173
Max. RCF (g-force)	3,134	3,134	3,134	3,077	3,086		3,095